

ICBIW-24



## FEATURES

Rigorously tested in our U.S. manufacturing facilities to ensure decades of use

Exceptional support from Customer Care team

Custom front panel and hardware allow for infinite design options.

Dual evaporators for constant, moderate humidity so corks don't dry out

Two independent temperature zones hold reds and whites at proper serving temperature

Bronze-tinted, UV-resistant glass protects against light exposure

Soft-on LED lighting illuminates gradually

Home security system connection

Wine racks accommodate 750 ml bottles, half-bottles and magnums.

Intuitive touch control panel keeps temps within one degree of set point

Star-K compliant with installation of a harness kit.

Illuminated display rack for prized bottles of wine.

Full-extension, easy-glide racks provide access without agitating wine

New inventory tiles system lets you label wine racks for easy ID

## ACCESSORIES

Dual installation kit for installation with another wine or integrated model

Stainless steel front panels with tubular or pro handles

Reduced toe kick divider for toe kicks from 10 cm to 5 cm

Side enclosure

Top enclosure

Solid overlay door

Stainless steel pro handles

Stainless steel tubular handles

Accessories are available through an authorized dealer.

For local dealer information, visit [subzero-wolf.com/locator](http://subzero-wolf.com/locator).



## HANDLE ACCESSORIES

PRO



TUBULAR



**PRODUCT SPECIFICATIONS**

Model	ICBIW-24
Dimensions	610mmW x 2134mmH x 610mmD
Door Clearance	572mm
Weight	185 kg
Electrical Supply	220-240 VAC; 50/60 Hz
Electrical Service	≤ 2 A
Wine Storage Capacity	102 Bottles
Receptacle	3-prong grounding-type

**ELECTRICAL**

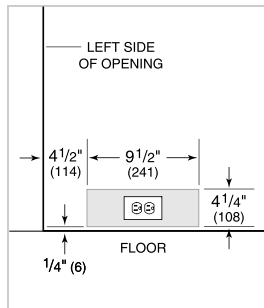

NOTE: Dimensions in parenthesis are in millimeters unless otherwise specified

**INTERIOR VIEW**

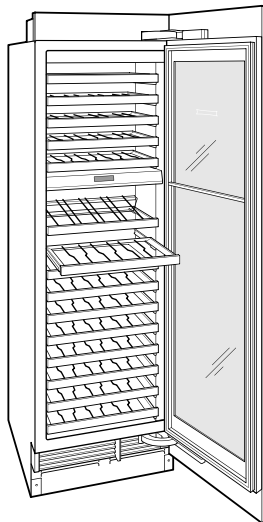

This illustration is intended for interior reference only and may not represent the exterior of the model being specified.

**DIMENSIONS**

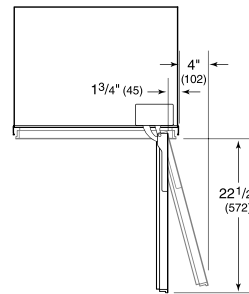
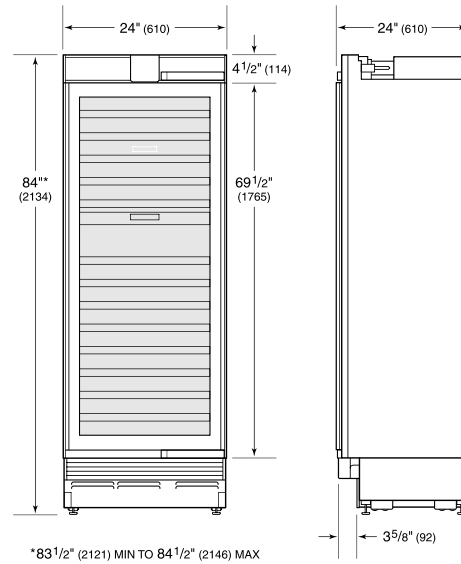

**STANDARD INSTALLATION**

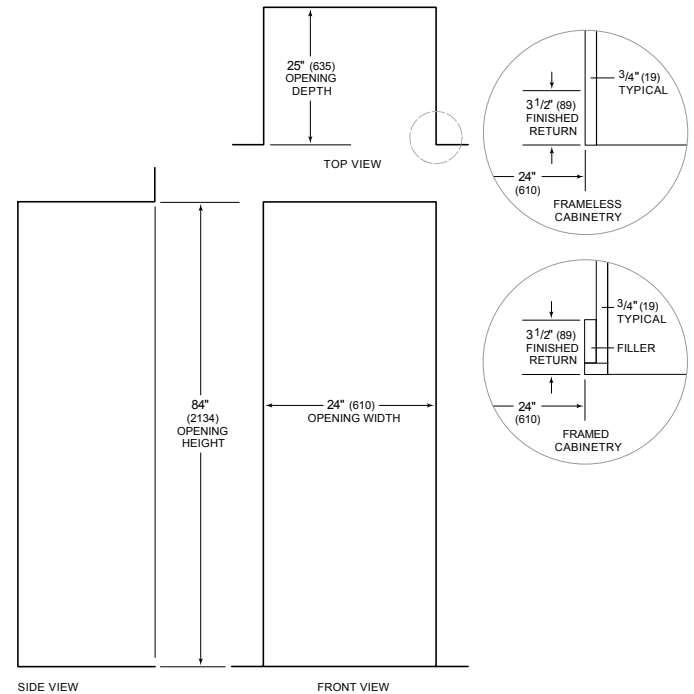

NOTE: 3 1/2" (89) finished returns will be visible and should be finished to match cabinetry